



# WAREHOUSE RACKING



**SELECTIVE PALLET RACKING**



**MEZZANINE FLOORS & RAISED STORAGE AREAS**

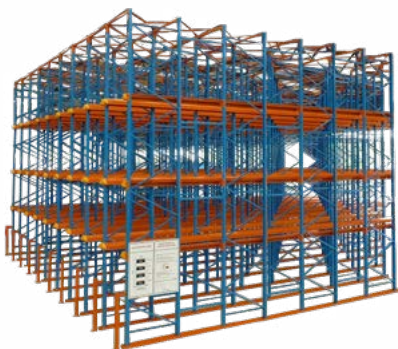

**DRIVE-IN RACKING**



**CANTILEVER RACKING**



**WAREHOUSE RACKING ACCESSORIES**

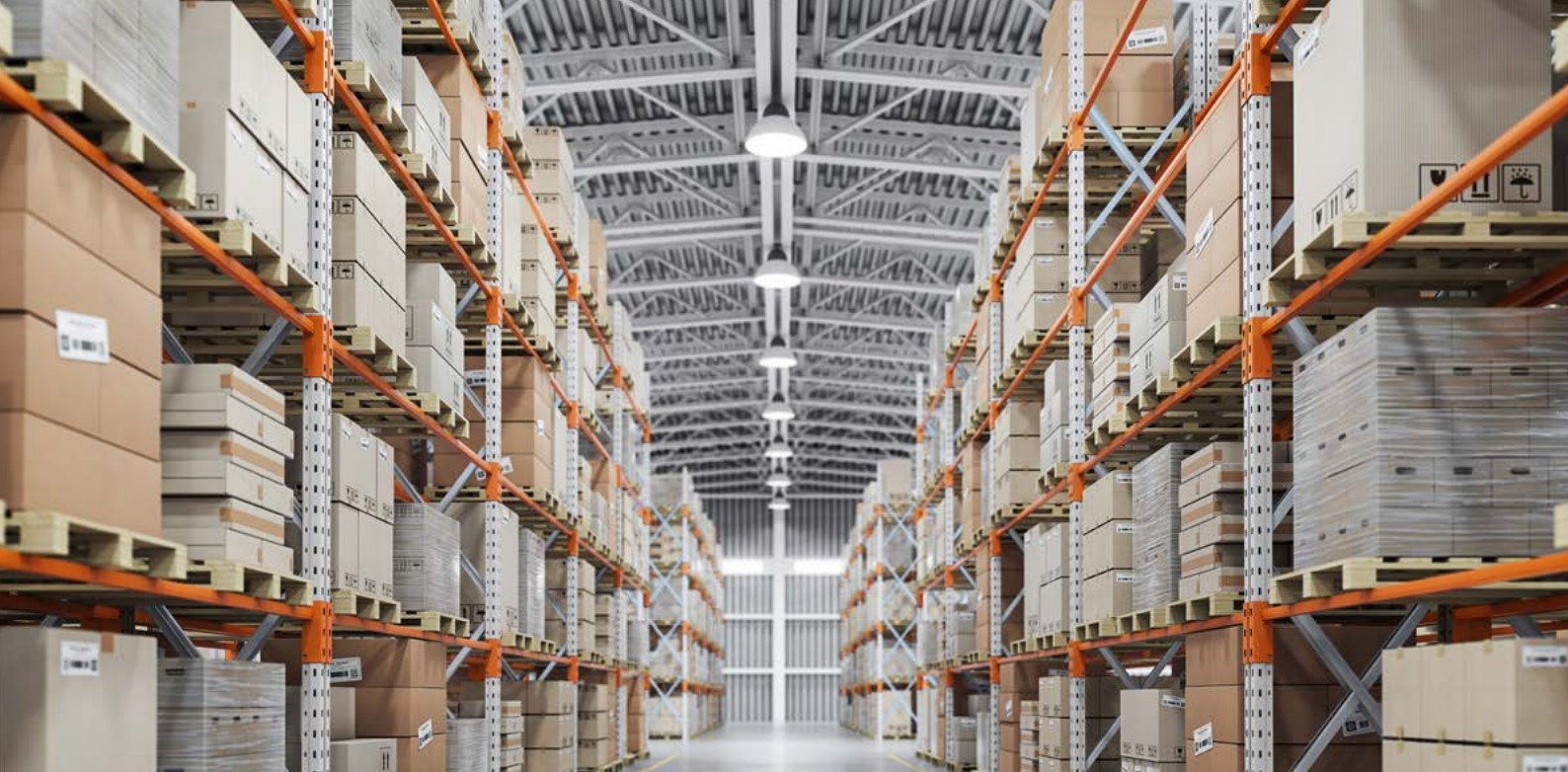

# SELECTIVE PALLET RACKING

Universal Racking System for Storing Multiple Pallets

This system offers the most economical, efficient storing and retrieval of pallets. It provides easy direct access to every pallet in storage and being available in an extensive range of sizes it is extremely versatile. This is why our Selective Racking System has been and still is the most popular choice for the past 10 years.

## Features

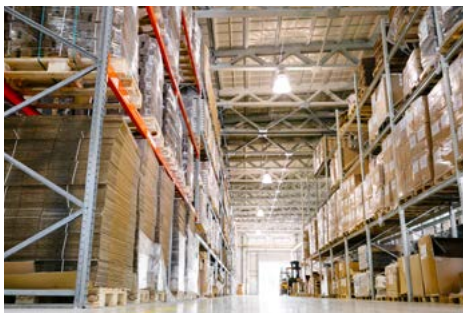

- Individual access to all pallets to full height of warehouse.
- Simple stock rotation achieved.
- Easy beam adjustment accommodates variable pallet heights.
- Compatible with many handling equipment styles.
- Conventional tolerance for floors when used to 10m high.
- Lower level pallets can be located on the floor (picking pallets).
- Accessories available can accommodate every unit load type.
- Economical shelving beams can be added for low level picking.
- High average locations used 95%, for 100% accessibility, good stock rotation.

## Selective Racking System Concept

Average Locations Used	95%
Immediate Accessibility	100%
Stock Rotation	Very Good
Floor Utilisation	40%

## Applications

- Palletised Goods
- Carpet Storage
- Tyre Racks
- Archive Storage
- High rise Shelving





The Unirack Range of Pallet Racking is our latest and most popular range of racking. It was specifically designed & manufactured for us. In times where the market is flooded with low quality products and inconsistent racking, we made it our priority to deliver the service our customers need and offer premium quality as well as maintain consistent high standards for 20 years now. We invite you to take a look at our products and you will see the difference.

## Unirack Range: Key Features

- Safety locking system that locks together
- Compatible with a number of existing systems
- Extra strong galvanised uprights
- Powdercoated beams with 5 hook connectors
- Various lengths, widths, heights available
- Heavy duty wrap around base plates with quality welds

## Unirack Range Beam



Powdercoated beams with 5 hook connectors

Beam Code	Length	Profile	Style
PRPB1372-75	1372 mm	75 x 45 mm	Box Beam
PRPB1829-75	1829 mm	75 x 45 mm	Box Beam
PRPB2591-75	2591 mm	75 x 45 mm	Box Beam
PRPB2591-90	2591 mm	90 x 45 mm	Box Beam
PRPB2591-110	2591 mm	110 x 45 mm	Box Beam
PRPB2591-130	2591 mm	130 x 45 mm	Box Beam
PRPB2591-150	2591 mm	150 x 45 mm	Box Beam
PRPB2743-75	2743 mm	75 x 45 mm	Box Beam
PRPB2743-90	2743 mm	90 x 45 mm	Box Beam
PRPB2743-110	2743 mm	110 x 45 mm	Box Beam
PRPB2743-130	2743 mm	130 x 45 mm	Box Beam
PRPB2743-150	2743 mm	150 x 45 mm	Box Beam
PRPB3048-110	3048 mm	110 x 45 mm	Box Beam
PRPB3048-130	3048 mm	130 x 45 mm	Box Beam
PRPB3048-150	3048 mm	150 x 45 mm	Box Beam
PRPB3810-130	3810 mm	130 x 45 mm	Box Beam
PRPB3810-150	3810 mm	150 x 45 mm	Box Beam
PRPSB1829	1829 mm	75 x 50 x 25 mm	Stepped Beam
PRPSB2591	2591 mm	75 x 50 x 25 mm	Stepped Beam

## Unirack Range Upright



Upright Code	Height	Width	Load Rating
PRPU2500-838	2500 mm	838 mm (Standard)	9000 kg
PRPU3000-838	3000 mm	838 mm (Standard)	9000 kg
PRPU3600-838	3600 mm	838 mm (Standard)	9000 kg
PRPU4200-838	4200 mm	838 mm (Standard)	9000 kg
PRPU4800-838	4800 mm	838 mm (Standard)	9000 kg
PRPU5800-838	5800 mm	838 mm (Standard)	9000 kg
PRPU6100-838	6100 mm	838 mm (Standard)	9000 kg
PRPU7500-838	7500 mm	838 mm (Standard)	9000 kg
PRPU2500-1219	2500 mm	1219 mm (Extra Wide)	9000 kg
RPU3000-1219	3000 mm	1219 mm (Extra Wide)	9000 kg
PRPU3600-1219	3600 mm	1219 mm (Extra Wide)	9000 kg
PRPU4200-1219	4200 mm	1219 mm (Extra Wide)	9000 kg
PRPU4800-1219	4800 mm	1219 mm (Extra Wide)	9000 kg
PRPU5800-1219	5800 mm	1219 mm (Extra Wide)	9000 kg
PRPU6100-1219	6100 mm	1219 mm (Extra Wide)	9000 kg
PRPU7500-1219	7500 mm	1219 mm (Extra Wide)	1522 kg



The Unidex range is our original and oldest range of Selective Pallet Racking, having stocked and sold it for 10 years. Over that time, we have fitted out supply warehouses, manufacturing facilities, retail centres, and other storage and distribution facilities with this range. Hence, we are confident that it lasts. The design has not changed since, so if you are looking at adding to an existing system, it will very likely match this range.

## Unidex Range: Key Features

- Safety locking system that locks together
- Easy to assemble and modify as required
- Long lasting galvanised uprights
- Powder coated beams with 4 hook connectors
- Various lengths, widths, heights available
- Heavy duty base plates

## Unidex Range Beam



Powdercoated beams with 4 hook connectors

Beam Code	Length	Profile	Style
B-1372	1372 mm	80 x 50 mm	Box Beam
B-1829	1829 mm	80 x 50 mm	Box Beam
B-2591-80	2591 mm	80 x 50 mm	Box Beam
B-2591-100	2591 mm	100 x 50 mm	Box Beam
B-2591-120	2591 mm	120 x 50 mm	Box Beam
B-2743-100	2743 mm	100 x 50 mm	Box Beam
B-2743-120	2743 mm	120 x 50 mm	Box Beam
B-3048-120	3048 mm	120 x 50 mm	Box Beam
B-3810-140	3810 mm	140 x 50 mm	Box Beam
B-1829ST	1829 mm	80 x 50 mm	Stepped Beam
B-2591ST	2591 mm	80 x 50 mm	Stepped Beam

## Unidex Range Upright



Upright Code	Height	Width	Load Rating
PRU914-838	914 mm	838 mm (Standard)	9000 kg
PRU2438-838	2438 mm	838 mm (Standard)	9000 kg
PRU3048-838	3048 mm	838 mm (Standard)	9000 kg
PRU3658-838	3658 mm	838 mm (Standard)	9000 kg
PRU4267-838	4267 mm	838 mm (Standard)	9000 kg
PRU4877-838	4877 mm	838 mm (Standard)	9000 kg
PRU5791-838	5791 mm	838 mm (Standard)	9000 kg
PRU6096-838	6096 mm	838 mm (Standard)	9000 kg
PRU6705-838	6705 mm	838 mm (Standard)	9000 kg
PRU7658-838	7658 mm	838 mm (Standard)	9000 kg
PRU2438-1219	2438 mm	1219 mm (Extra Wide)	9000 kg
PRU3048-1219	3048 mm	1219 mm (Extra Wide)	9000 kg
PRU3658-1219	3658 mm	1219 mm (Extra Wide)	9000 kg
PRU4267-1219	4267 mm	1219 mm (Extra Wide)	9000 kg
PRU4877-1219	4877 mm	1219 mm (Extra Wide)	9000 kg
PRU5791-1219	5791 mm	1219 mm (Extra Wide)	9000 kg
PRU6096-1219	6096 mm	1219 mm (Extra Wide)	9000 kg
PRU7658-1219	7658 mm	1219 mm (Extra Wide)	9000 kg
PRU914-1219	914 mm	1219 mm (Extra Wide)	9000 kg

# SELECTIVE PALLET RACKING COMPONENTS



Row Spacer



Wire Decking



Heavy Duty Base Plate



Shim Plate



Bracing



Corner Protector

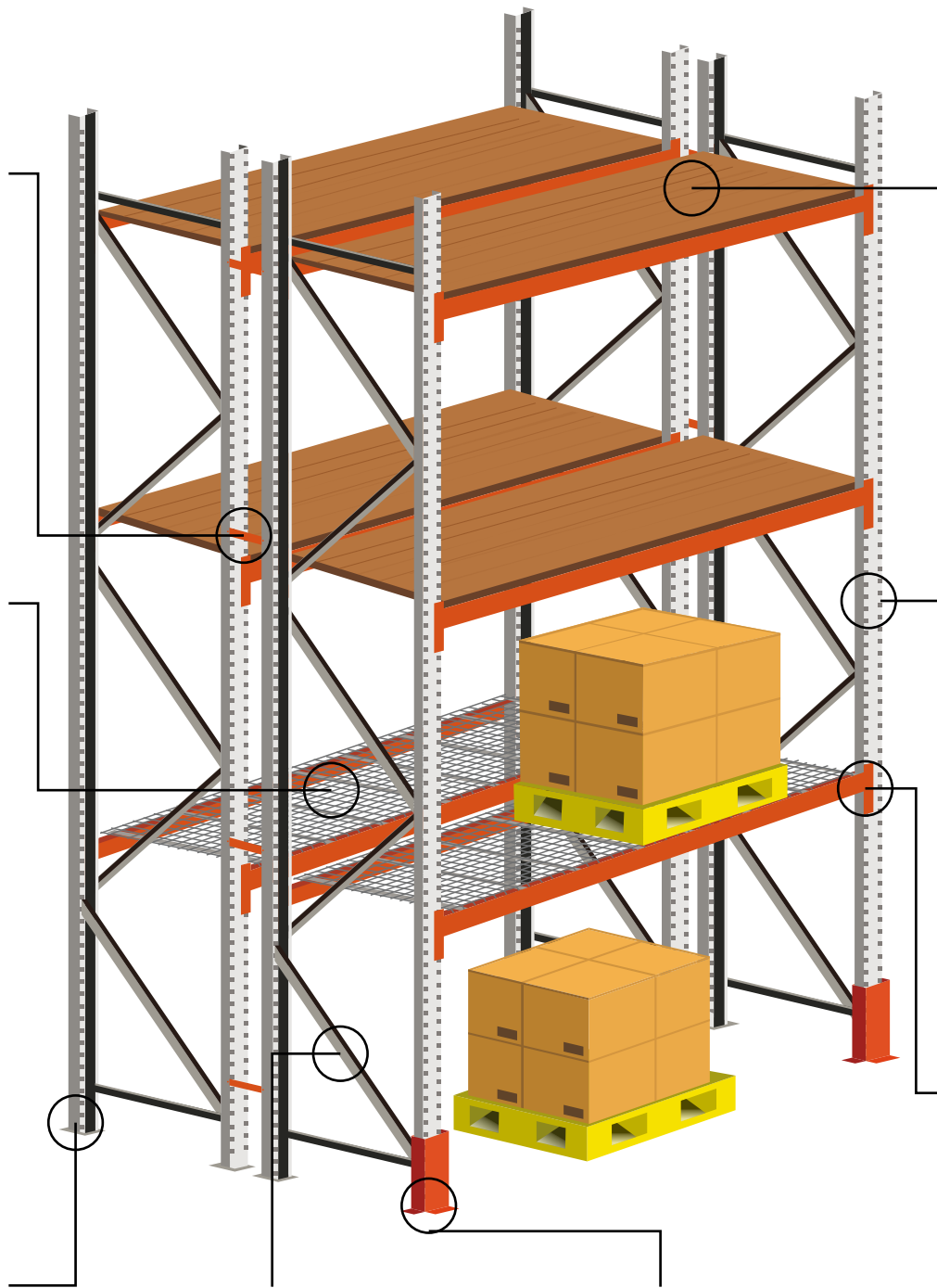

Particle Board



Upright Frame



Beams





# MEZZANINE FLOORS & RAISED STORAGE AREAS

Maximise Warehouse Space with Mezzanine Floors

Mezzanine floors systems are a cost-effective way to maximise floor space and improve productivity in warehouse and factory environments.

At Unirack, we have three types of mezzanine variations: Racking, Longspan and Structural Steel Mezzanine Floors.



## Racking Mezzanine Floor System

Rack-based mezzanines can be multi-tiered, doubling or tripling the available surface area



## Longspan Mezzanine System

A cost-effective and flexible storage solution for those looking to maximise storage density



## Structural Mezzanine System

Structural mezzanine floors are a heavy-duty solution constructed from structural steel posts and beams

## Mezzanine Floors System Concept

Average Locations Used	90%
Immediate Accessibility	40%
Stock Rotation	Average
Floor Utilisation	60%

## Applications

- Parts Storage & Picking
- Instant Workshop
- Vehicle Storage
- Office/Retail Area
- Archive Storage





# DRIVE-IN RACKING

Ideal For High Density Pallet Storage

Are your pallets evenly packed & stored? Do you need to maximise space? Do you have high-volume? Then give us a call and let us explain why Drive-In racking systems are more and more popular. With unique self-centring rails position pallets quickly, easily and safely. Works with conventional forklifts and perfect for maximising areas such as cool rooms.



## Drive-In Racking System Concept

Average Locations Used	70%
Immediate Accessibility	75%
Stock Rotation	Average
Floor Utilisation	80%

## Applications

- Food & Beverage Facilities
- Cold Storage Facilities
- High Density Pallet Storage





# CANTILEVER RACKING

Perfect Solution For Storing Heavy Long Packs Such As Lengths Of Timber

Cantilever Racking is used for storage of very long items such as carpet, timber, pipe, etc. It is open and therefore easier to place and remove stock.

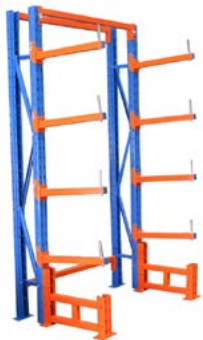

## Light Duty Cantilever

Light Duty Cantilever comes standard as 2500mm high & 1200mm wide but can be configured to 3600mm & 4800mm in height as well as 1800mm in width. Any questions please call your local branch.



## Medium Duty Cantilever

Medium Duty Cantilever comes standard as 3600mm and 4800mm high & 1200mm wide but can be configured upto 6000mm in height as well as 1500mm in width. Any questions please call your local branch.

## Cantilever Racking System Concept

Average Locations Used	90%
Immediate Accessibility	50%
Stock Rotation	Average
Floor Utilisation	60%

## Applications

- Fabrication Facilities
- Steel Merchant Facilities
- Automotive Facilities
- Garden Supply Facilities
- Hardware Supply Facilities
- Timber Merchant Facilities
- Furniture Supply Facilities
- Plumbing Supply Facilities



# LIGHT DUTY CANTILEVER



## 2500MM HIGH LIGHT DUTY CANTILEVER - SINGLE SIDED

Code	Bay (W)	Arm (L)	Load per Arm	First Bay Inc GST	Extra Bay Inc GST
CLL-2560-3-S	1200 mm	600 mm	300 kg	\$830.00	\$460.00
CLL-2590-3-S	1200 mm	900 mm	200 kg	\$880.00	\$485.00
CLL-2560-4-S	1200 mm	600 mm	300 kg	\$910.00	\$500.00
CLL-2590-4-S	1200 mm	900 mm	200 kg	\$970.00	\$530.00
CLL-2560-5-S	1200 mm	600 mm	300 kg	\$990.00	\$540.00
CLL-2590-5-S	1200 mm	900 mm	200 kg	\$1,060.00	\$575.00
CLL-2560-6-S	1200 mm	600 mm	300 kg	\$1,070.00	\$580.00
CLL-2590-6-S	1200 mm	900 mm	200 kg	\$1,150.00	\$620.00



## 2500MM HIGH LIGHT DUTY CANTILEVER - DOUBLE SIDED

Code	Bay (W)	Arm (L)	Load per Arm	First Bay Inc GST	Extra Bay Inc GST
CLL-2560-3-D	1200 mm	600 mm	300 kg	\$1,210.00	\$650.00
CLL-2590-3-D	1200 mm	900 mm	200 kg	\$1,310.00	\$700.00
CLL-2560-4-D	1200 mm	600 mm	300 kg	\$1,370.00	\$730.00
CLL-2590-4-D	1200 mm	900 mm	200 kg	\$1,490.00	\$790.00
CLL-2560-5-D	1200 mm	600 mm	300 kg	\$1,530.00	\$810.00
CLL-2590-5-D	1200 mm	900 mm	200 kg	\$1,670.00	\$880.00
CLL-2560-6-D	1200 mm	600 mm	300 kg	\$1,690.00	\$890.00
CLL-2590-6-D	1200 mm	900 mm	200 kg	\$1,850.00	\$970.00

# MEDIUM DUTY CANTILEVER

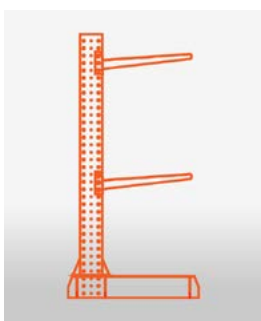

## 3600MM AND 4800MM HIGH MEDIUM DUTY CANTILEVER - SINGLE SIDED

Code	Bay (W)	Arm (L)	Load per Arm	First Bay Inc GST	Extra Bay Inc GST
CLM-3612-3-S	1200 mm	1200 mm	500 kg	\$1,998.00	\$1,053.00
CLM-3615-3-S	1500 mm	1200 mm	500 kg	\$2,020.00	\$1,075.00
CLM-3612-4-S	1200 mm	1200 mm	500 kg	\$2,188.00	\$1,148.00
CLM-3615-4-S	1500 mm	1200 mm	500 kg	\$2,210.00	\$1,170.00
CLM-3612-5-S	1200 mm	1200 mm	500 kg	\$2,378.00	\$1,243.00
CLM-3615-5-S	1500 mm	1200 mm	500 kg	\$2,400.00	\$1,265.00
CLM-3612-6-S	1200 mm	1200 mm	500 kg	\$2,568.00	\$1,338.00
CLM-3615-6-S	1500 mm	1200 mm	500 kg	\$2,590.00	\$1,360.00
CLM-4812-3-S	1200 mm	1200 mm	500 kg	\$2,404.00	\$1,299.00
CLM-4815-3-S	1500 mm	1200 mm	500 kg	\$2,450.00	\$1,345.00
CLM-4812-4-S	1200 mm	1200 mm	500 kg	\$2,594.00	\$1,394.00
CLM-4815-4-S	1500 mm	1200 mm	500 kg	\$2,640.00	\$1,440.00
CLM-4812-5-S	1200 mm	1200 mm	500 kg	\$2,784.00	\$1,489.00
CLM-4815-5-S	1500 mm	1200 mm	500 kg	\$2,830.00	\$1,535.00
CLM-4812-6-S	1200 mm	1200 mm	500 kg	\$2,974.00	\$1,584.00
CLM-4815-6-S	1500 mm	1200 mm	500 kg	\$3,020.00	\$1,630.00

## 3600MM AND 4800MM HIGH MEDIUM DUTY CANTILEVER - DOUBLE SIDED

Code	Bay (W)	Arm (L)	Load per Arm	First Bay Inc GST	Extra Bay Inc GST
CLM-3612-3-D	1200 mm	1200 mm	500 kg	\$2,628.00	\$1,368.00
CLM-3615-3-D	1500 mm	1200 mm	500 kg	\$2,650.00	\$1,390.00
CLM-3612-4-D	1200 mm	1200 mm	500 kg	\$3,008.00	\$1,558.00
CLM-3615-4-D	1500 mm	1200 mm	500 kg	\$3,030.00	\$1,580.00
CLM-3612-5-D	1200 mm	1200 mm	500 kg	\$3,388.00	\$1,748.00
CLM-3615-5-D	1500 mm	1200 mm	500 kg	\$3,410.00	\$1,770.00
CLM-3612-6-D	1200 mm	1200 mm	500 kg	\$3,768.00	\$1,938.00
CLM-3615-6-D	1500 mm	1200 mm	500 kg	\$3,790.00	\$1,960.00
CLM-4812-3-D	1200 mm	1200 mm	500 kg	\$3,034.00	\$1,614.00
CLM-4815-3-D	1500 mm	1200 mm	500 kg	\$3,080.00	\$1,660.00
CLM-4812-4-D	1200 mm	1200 mm	500 kg	\$3,414.00	\$1,804.00
CLM-4815-4-D	1500 mm	1200 mm	500 kg	\$3,460.00	\$1,850.00
CLM-4812-5-D	1200 mm	1200 mm	500 kg	\$3,794.00	\$1,994.00
CLM-4815-5-D	1500 mm	1200 mm	500 kg	\$3,840.00	\$2,040.00
CLM-4812-6-D	1200 mm	1200 mm	500 kg	\$4,174.00	\$2,184.00
CLM-4815-6-D	1500 mm	1200 mm	500 kg	\$4,220.00	\$2,230.00

NOTE: All prices are subject to change without prior notice

# WAREHOUSE RACKING ACCESSORIES



WIRE DECKING, 1200 X 838MM



PALLET RACKING CENTRE SUPPORT CABLE DRUM BRACKET PER PAIR ( 2 BRACKETS) PAIR 838MM DEEP



PALLET RACKING UPRIGHT PROTECTOR (L-SHAPED)



PALLET RACKING UPRIGHT PROTECTOR (U-SHAPED)

## UNIRACK RANGE PALLET RACKING ACCESSORIES

Code	Product Name
PR-DYNA75	Dyna Bolt - 75
ML-L	Magnetic Label Large
ML-M	Magnetic Label Medium
PR-HDBP	Heavy Duty Base Plate
PR-MDF1829-25-ST	MDF Board - 1829
PR-MDF2591-25-ST	MDF Board - 2591
PR-PB1372-18-835	Particle Board - 1372
PR-PB1829-18-835	Particle Board - 1829
PR-PB2591-18-835	Particle Board - 2591
PR-PB2743-18-835	Particle Board - 2743
PR-PB3048-18-835	Particle Board - 3048
PR-SDW	Shelf Divider
PR-WD-GAL-1350x1220	Galvanised Wire Decking
PR-WD-GAL-1350x840	Galvanised Wire Decking
PR-WD-GAL-1250x840	Galvanised Wire Decking
PR-WD-GAL-1250x1220	Galvanised Wire Decking
PRB-LP	Locking Pins
PRP-CAP	End Cap
PRP-CCRDH-838	Pallet Racking Support Cable
PRP-DA750	Divider Arm 750mm
PRP-FBM1372-1000	Fall Barrier Mesh
PRP-FBM1372-1500	Fall Barrier Mesh
PRP-FBM2591-1000	Fall Barrier Mesh
PRP-FBM2591-1500	Fall Barrier Mesh
PRP-FBM2743-1000	Fall Barrier Mesh
PRP-FBM2743-1500	Fall Barrier Mesh
PRP-FBMB	Mounting Bracket
PRP-FEB-1219	Fork Entry Bars
PRP-FEB-838	Fork Entry Bars
PR-JLOCK	J Lock - Pair (Left & Right)
PRP-RS457	Row Spacers
PRP-SHIM1MM	Shim Plate
PRP-SHIM5MM	Shim Plate
PRP-SPLICE	Pallet Racking Splice Kit
PRP-TSB1219	Timber Support Bars
PRP-TSB838	Timber Support Bars
PRP-UPL	L Type Corner Protector
PRP-UPU	U Type Corner Protector
PRP-WB	Pallet Racking Wheel Bracket
PRP-WHB	Pallet Racking Prestar Wheel
PRP-WHNB	Pallet Racking Prestar Wheel
SWLS	Safe Working Load Sticker
SWS	Safe Working Sign
Zclips	Z Clips



PALLET RACKING WHEEL SET OF 4 BY 80MM



ROW SPACERS - PALLET RACKING

## UNIDEX RANGE PALLET RACKING ACCESSORIES

Code	Product Name
LP-PR838	Louvered Panel 838/450
PR-DYNA75	Dyna Bolt - 75
PR-HDBP-90	Heavy Duty Base Plate
PR-HDBPS90	Heavy Duty Base Plate
PR-BPS90-1	Leveling Plate 1mm
PR-BPS90-5	Leveling Plate 5mm
PR-MDF1829-25-ST	MDF Board - 1829
PR-MDF2591-25-ST	MDF Board - 2591
PR-PB1372-18-835	Particle Board - 1372
PR-PB1829-18-835	Particle Board - 1829
PR-PB2591-18-835	Particle Board - 2591
PR-PB2743-18-835	Particle Board - 2743
PR-PB3048-18-835	Particle Board - 3048
PR-SDW	Shelf Divider
PR-WD-GAL-1250x1220	Galvanised Wire Decking
PR-WD-GAL-1250x840	Galvanised Wire Decking
PR-WD-GAL-1350x1220	Galvanised Wire Decking
PR-WD-GAL-1350x840	Galvanised Wire Decking
PR-WHEELNB80	Pallet Racking Wheel Castor)
PR-WHEELNB90	Pallet Racking Wheel (Castor)
PR-WHEELWB80	Pallet Racking Wheel (Castor)
PR-WHEELWB90	Pallet Racking Wheel (Castor)
PRB-LP	Locking Pins
PRP-CAP	End Cap
SR76FP5022	Double End Row Protector
SR76FP5090	Single End Row Protector
SWLS	Safe Working Load Sticker
SWS	Safe Working Sign
Zclips	Z Clips